



# Zed Purlin/Rails

## STANDARD DETAILING SHEET

A. Steadman & Son Ltd  
Warnell • Welton • Carlisle  
Cumbria • CA5 7HH

Tel (0169 74) 78277 • Fax (0169 74) 78530

CUSTOMER: A. Customer SECTION NO: P3 170/16 DOCUMENT NO: \_\_\_\_\_ PAGE 1 OF 1 REV: A  
CUSTOMER ORDER NO: 123456 CUSTOMER DRAWING NO: 2000-1 DRAWN BY: A. Customer DATE: 1/1/2000

Material S350G

14mm dia Holes for 12mm dia grade 8.8 bolts.  
Purlin Anti Sag Bar Holes 14mm Sq.

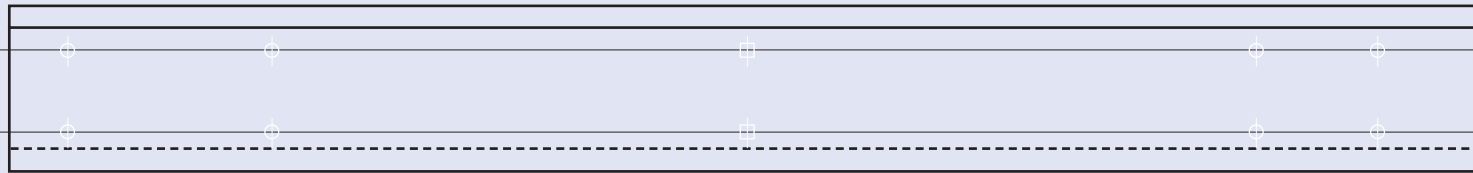
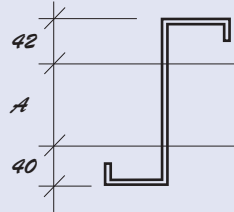

Dimension A

SECTION DEPTH	DIM A	SLEEVE HOLE CRS
140	58	235
170	88	285
200	118	335
240	158	435
300	218	SPECIAL

2 REQUIRED AS DRAWN

2 REQUIRED OPPOSITE HAND

MARK e1

MARK e2

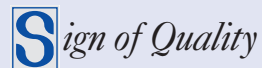

PHOTOCOPY THIS SHEET ON A LIGHT SETTING TO REMOVE EXAMPLE SHOWN



# Cee Rails

## STANDARD DETAILING SHEET

A. Steadman & Son Ltd  
Warnell • Welton • Carlisle  
Cumbria • CA5 7HH

Tel (0169 74) 78277 • Fax (0169 74) 78530

CUSTOMER: A. Customer SECTION NO: RC 170/16 DOCUMENT NO: \_\_\_\_\_ PAGE 1 OF 1 REV: 1

CUSTOMER ORDER NO: 123/2000 CUSTOMER DRAWING NO: 123/2000 DRAWN BY: A. Customer DATE: 12/13/2000

Material S350G

All holes 14mm dia for 12mm dia bolts.

Show counterformed holes thus:  on plan

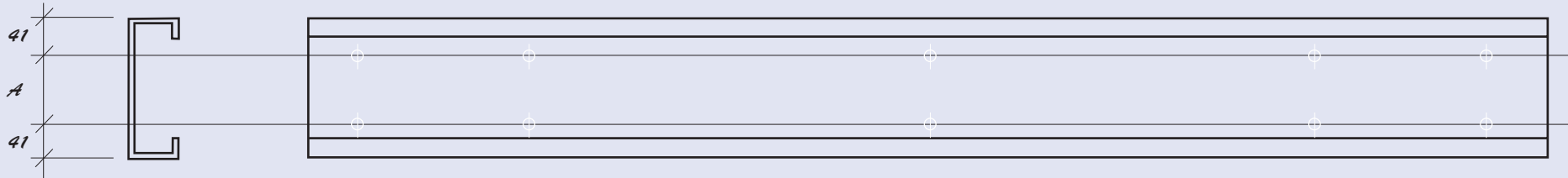

Dimension A

SECTION DEPTH	DIM A	SLEEVE HOLE CRS
140	58	235
170	88	285
200	118	335
240	158	435
300	218	SPECIAL

2 REQUIRED AS DRAWN

2 REQUIRED OPPOSITE HAND

MARK e1

MARK e2



PHOTOCOPY THIS SHEET ON A LIGHT SETTING TO REMOVE EXAMPLE SHOWN



# Cee Sections

## STANDARD DETAILING SHEET

A. Steadman & Son Ltd  
 Warnell • Welton • Carlisle  
 Cumbria • CA5 7HH

Tel (0169 74) 78277 • Fax (0169 74) 78530

CUSTOMER: A. Customer SECTION NO: C 140/14 DOCUMENT NO: \_\_\_\_\_ PAGE 1 OF 1 REV: 1  
 CUSTOMER ORDER NO: 123/2000 CUSTOMER DRAWING NO: 123/2000 DRAWN BY: A. Customer DATE: 12/13/2000

Material S350G

All holes 14mm dia for 12mm dia bolts.

Show counterformed holes thus:  on plan in Web

and thus:  in Flanges

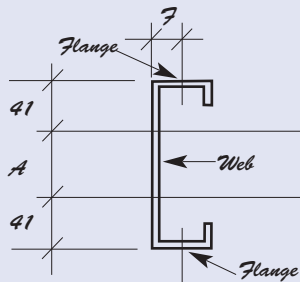

Dimensions A & B

SECTION DEPTH	DIM A	DIM F
140	58	31
170	88	31
200	118	35
240	158	37
300	218	47



2 REQUIRED AS DRAWN  
2 REQUIRED OPPOSITE HAND

MARK C1  
 MARK C2



PHOTOCOPY THIS SHEET ON A LIGHT SETTING TO REMOVE EXAMPLE SHOWN

CUSTOMER: A. Customer SECTION NO: 123/2000 DOCUMENT NO: \_\_\_\_\_ PAGE 1 OF 1 REV: 1  
 CUSTOMER ORDER NO: 123/2000 CUSTOMER DRAWING NO: 123/2000 DRAWN BY: A. Customer DATE: 12/13/2000

### STANDARD SLEEVES (Material S350G -, all holes 14mm dia for 12mm dia grade 8.8 bolts)

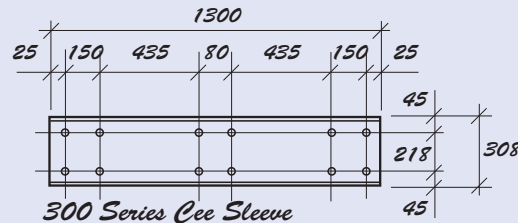
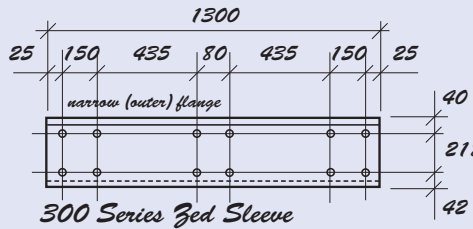
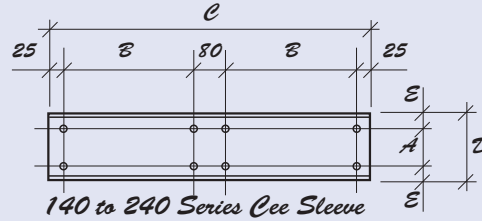
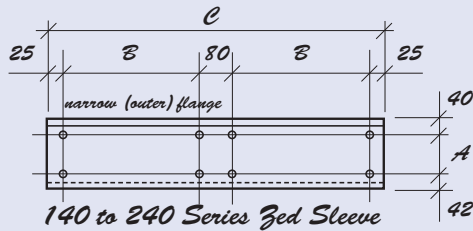

When specifying Cee sleeves, only the depth of the section is required

SECTION DEPTH	A	B	C	D	E
140	58	235	600	146	44
170	88	285	700	177	44.5
200	118	335	800	207	44.5
240	158	435	1060	248	45
300	REFER TO DIAGRAM FOR DIMENSIONS				

Note that only one thickness of Cee is available for each depth of section.  
 t=2.0 for 140 series  
 t=2.5 for 170 and 200 series  
 t=3.0 for 240 and 300 series

MARK	SECTION	CEE or ZED	NUMBER REQUIRED

### FIREWALL SLEEVES (Material S350G -, all slots 14mm dia x 45 long for 12mm dia grade 8.8 bolts)

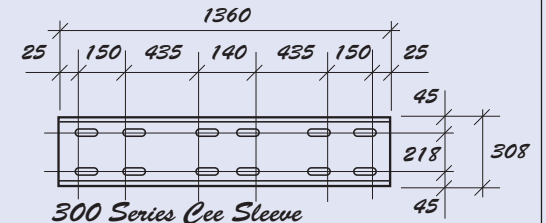
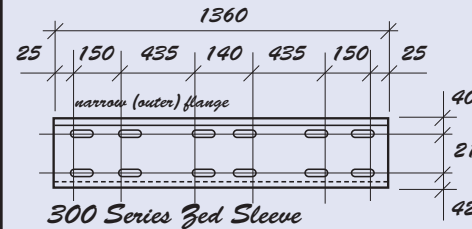
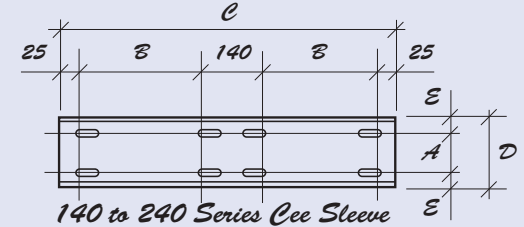
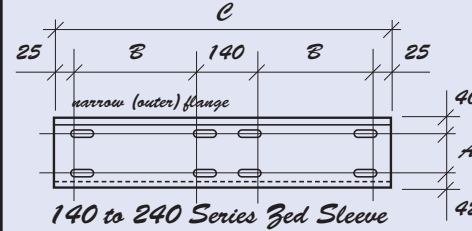

When specifying Cee sleeves, only the depth of the section is required

SECTION DEPTH	A	B	C	D	E
140	58	235	660	146	44
170	88	285	760	177	44.5
200	118	335	860	207	44.5
240	158	435	1060	248	45
300	REFER TO DIAGRAM FOR DIMENSIONS				

Note that only one thickness of Cee is available for each depth of section.  
 t=2.0 for 140 series  
 t=2.5 for 170 and 200 series  
 t=3.0 for 240 and 300 series

MARK	SECTION	CEE or ZED	NUMBER REQUIRED



# Eaves Beams (200 & 240 SERIES)

## STANDARD DETAILING SHEET

A. Steadman & Son Ltd  
Warnell • Welton • Carlisle  
Cumbria • CA5 7HH

Tel (0169 74) 78277 • Fax (0169 74) 78530

CUSTOMER: A. Customer SECTION NO: EB 200/20 DOCUMENT NO: \_\_\_\_\_ PAGE 1 OF 1 REV: 1

CUSTOMER ORDER NO: 123/2000 CUSTOMER DRAWING NO: 123/2000 DRAWN BY: A. Customer DATE: 12/13/2000

Material S350G

All holes 14mm dia for 12mm dia grade 8.8 bolts.

Angle  $\alpha = 105^\circ$   
(-Ve Angles Available)

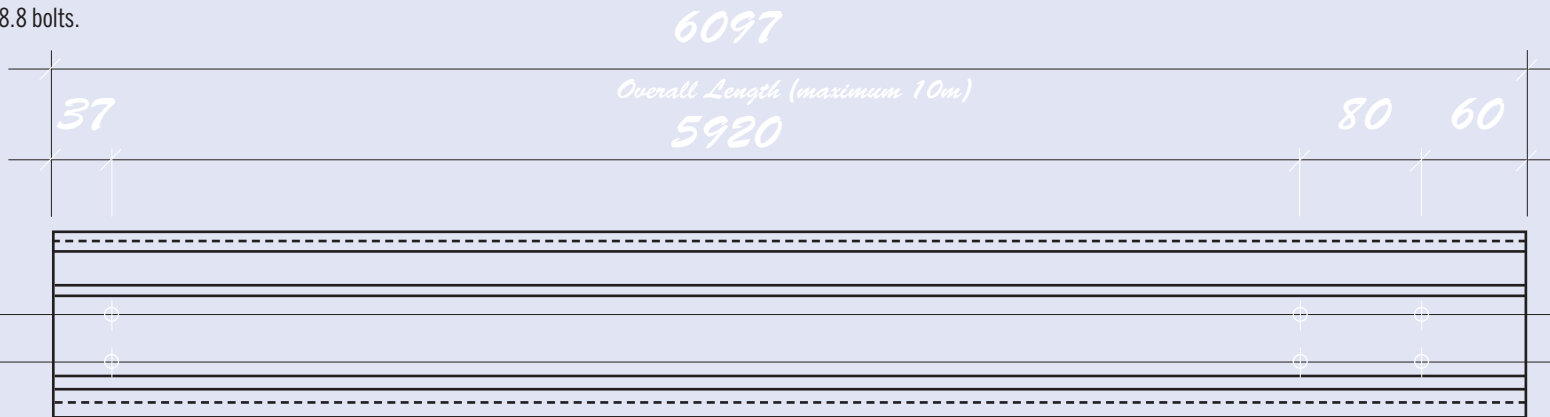
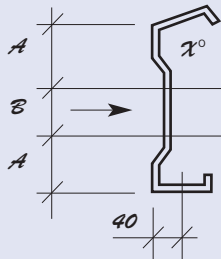

(VIEWED IN DIRECTION OF ARROW)

Dimensions A & B

SECTION DEPTH	DIM A	DIM B
200	65	70
240	65	110

2 REQUIRED AS DRAWN

MARK e1

2 REQUIRED OPPOSITE HAND

MARK e2



PHOTOCOPY THIS SHEET ON A LIGHT SETTING  
TO REMOVE EXAMPLE SHOWN



# Eaves Beams (300 SERIES)

## STANDARD DETAILING SHEET

A. Steadman & Son Ltd  
 Warnell • Welton • Carlisle  
 Cumbria • CA5 7HH  
 Tel (0169 74) 78277 • Fax (0169 74) 78530

CUSTOMER: A. Customer SECTION NO: EB 300/30 DOCUMENT NO: \_\_\_\_\_ PAGE 1 OF 1 REV: 1  
 CUSTOMER ORDER NO: 123/2000 CUSTOMER DRAWING NO: 123/2000 DRAWN BY: A. Customer DATE: 12/13/2000

Material S350G

All holes 14mm dia for 12mm dia grade 8.8 bolts.

Show counterformed holes thus:  on plan in Web

and thus:  in Flanges

Angle  $\alpha = 105^\circ$   
 (-Ve Angles Available)

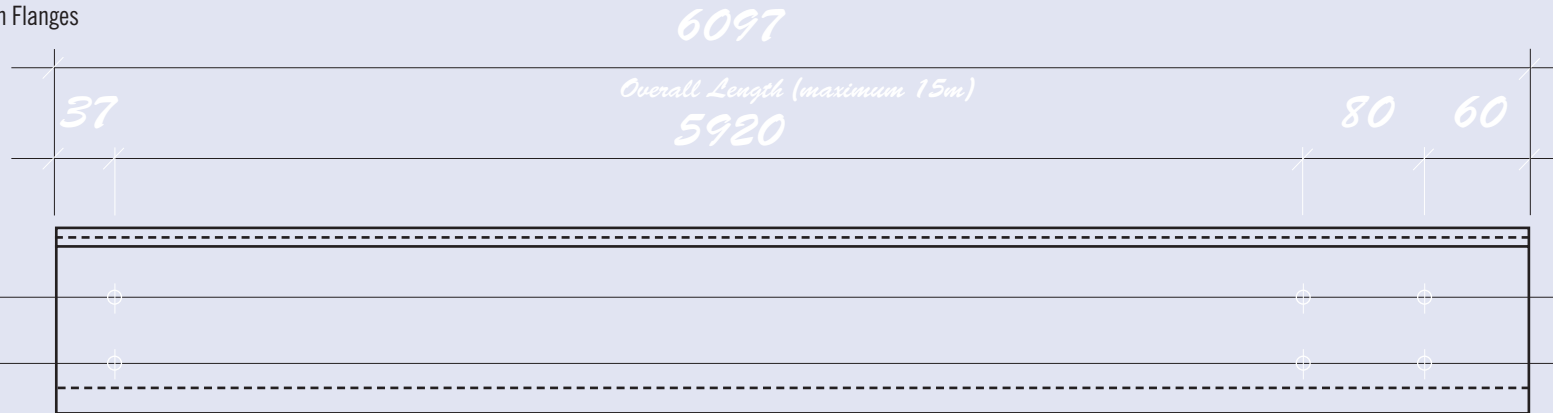
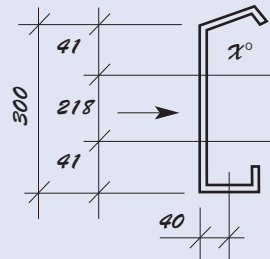

(VIEWED IN DIRECTION OF ARROW)

2 REQUIRED AS DRAWN

MARK e1

2 REQUIRED OPPOSITE HAND

MARK e2



PHOTOCOPY THIS SHEET ON A LIGHT SETTING TO REMOVE EXAMPLE SHOWN







CUSTOMER: A. Customer SECTION NO: 123/2000 DOCUMENT NO: \_\_\_\_\_ PAGE 1 OF 1 REV: 1  
 CUSTOMER ORDER NO: 123/2000 CUSTOMER DRAWING NO: 123/2000 DRAWN BY: A. Customer DATE: 12/13/2000

Standard Purlin and Rail Cleats					Short Trimmer Cleats			Packer Plate																																
<p>M14 holes in long leg of cleat for M12 8.8 bolts.</p> <p><b>BOLTED CLEAT</b>      <b>WELDED CLEAT</b></p> <p>Dimension A</p> <table border="1"> <thead> <tr> <th>SECTION DEPTH</th> <th>DIM A</th> </tr> </thead> <tbody> <tr><td>140</td><td>58</td></tr> <tr><td>170</td><td>88</td></tr> <tr><td>200</td><td>118</td></tr> <tr><td>240</td><td>158</td></tr> <tr><td>300</td><td>218</td></tr> </tbody> </table> <p>Cleats formed from 3mm S355 material. Heavy duty cleats with welded stiffeners available on request.</p>					SECTION DEPTH	DIM A	140	58	170	88	200	118	240	158	300	218	<p><b>Short Trimmer Cleats</b></p> <p>Material = 3mm thick zinc plated steel. 14mm dia holes.</p> <p>Dimension A</p> <table border="1"> <thead> <tr> <th>SECTION DEPTH</th> <th>DIM A</th> </tr> </thead> <tbody> <tr><td>140</td><td>58</td></tr> <tr><td>170</td><td>88</td></tr> <tr><td>200</td><td>118</td></tr> <tr><td>240</td><td>158</td></tr> <tr><td>300</td><td>218</td></tr> </tbody> </table>			SECTION DEPTH	DIM A	140	58	170	88	200	118	240	158	300	218	<p><b>Packer Plate</b></p> <p>6mm thick steel. 36mm dia holes.</p>								
SECTION DEPTH	DIM A																																							
140	58																																							
170	88																																							
200	118																																							
240	158																																							
300	218																																							
SECTION DEPTH	DIM A																																							
140	58																																							
170	88																																							
200	118																																							
240	158																																							
300	218																																							
SECTION DEPTH	BOLTED CLEAT	WELDED CLEAT	FINISH	NUMBER REQUIRED	MARK	SECTION DEPTH	NUMBER REQUIRED	MARK	B	NUMBER REQUIRED	MARK																													
Fire-Wall Purlin and Rail Cleats					Long Trimmer Cleats			Rail End Cleat																																
<p><b>Normal Cleat</b>      <b>Heavy Duty Cleat</b></p> <p>See above for Dimension A</p> <p>t = 6mm for 140, 170, and 200 series          t = 8mm for 240 and 300 series</p>					<p><b>Long Trimmer Cleats</b></p> <p>Dimension A</p> <table border="1"> <thead> <tr> <th>DEPTH</th> <th>DIMENSION A</th> <th>DIMENSION G</th> </tr> </thead> <tbody> <tr><td>140</td><td>58</td><td>110</td></tr> <tr><td>170</td><td>88</td><td>110</td></tr> <tr><td>200</td><td>118</td><td>110</td></tr> <tr><td>240</td><td>158</td><td>125</td></tr> <tr><td>300</td><td>218</td><td>135</td></tr> </tbody> </table>			DEPTH	DIMENSION A	DIMENSION G	140	58	110	170	88	110	200	118	110	240	158	125	300	218	135	<p><b>Rail End Cleat</b></p> <p>Dimension A</p> <table border="1"> <thead> <tr> <th>SECTION DEPTH</th> <th>DIM A</th> </tr> </thead> <tbody> <tr><td>140</td><td>58</td></tr> <tr><td>170</td><td>88</td></tr> <tr><td>200</td><td>118</td></tr> <tr><td>240</td><td>158</td></tr> <tr><td>300</td><td>218</td></tr> </tbody> </table>			SECTION DEPTH	DIM A	140	58	170	88	200	118	240	158	300	218
DEPTH	DIMENSION A	DIMENSION G																																						
140	58	110																																						
170	88	110																																						
200	118	110																																						
240	158	125																																						
300	218	135																																						
SECTION DEPTH	DIM A																																							
140	58																																							
170	88																																							
200	118																																							
240	158																																							
300	218																																							
SECTION DEPTH	NORMAL CLEAT	HEAVY CLEAT	FINISH	NUMBER REQUIRED	MARK	SECTION DEPTH	NUMBER REQUIRED	MARK	SECTION DEPTH	NUMBER REQUIRED	MARK																													

CUSTOMER: A. Customer SECTION NO: 123/2000 DOCUMENT NO: \_\_\_\_\_ PAGE 1 OF 1 REV: 1  
 CUSTOMER ORDER NO: 123/2000 CUSTOMER DRAWING NO: 123/2000 DRAWN BY: A. Customer DATE: 12/13/2000

### Angle Stay

Material = 45 x 45 x 2 zinc plated steel.  
14mm dia holes.

### Rail Closer

Material = 45 x 70 x 2 zinc plated steel.  
14mm dia holes.

### 45 x 45 Cleader Angle

Material = 45 x 45 x 2mm zinc plated steel.

### Stay Cleat

Material = 70 x 70 x 6 galvanised angle.  
14mm dia holes.

L	NUMBER REQUIRED	MARK

L	NUMBER REQUIRED	MARK

NUMBER REQUIRED	L (if required)	MARK

NUMBER REQUIRED	MARK

### Eaves Stiffening Cleat

SECTION DEPTH	DIM B
200	70
240	110
300	218

6mm thick GALV Bracket 14mm dia holes for grade 8.8 bolts

### Rail Corner Joining Plate

Material = 3mm zinc plated steel.

### 100 x 100 Cleader Angle

Material = 100 x 100 x 2mm zinc plated steel.

EAVES BEAM	E	H	NUMBER REQUIRED	MARK

A	C	NUMBER REQUIRED	MARK

NUMBER REQUIRED	L (if required)	MARK