

PROJECT PROFILE

TWOEY TOYS

Project summary

Project:

Multi-purpose manufacturing facility for Twoey Toys, Wigton

Products:

AS35 composite panels, flashings and accessories

Designer:

Alpha Design

Main contractor:

Thomas Armstrong Construction Ltd

Cladding contractor:

PMS Fabrications Ltd



PROJECT PROFILE

TWOEY TOYS



Twoey Toys is a Cumbria based company manufacturing and supplying high quality wooden toys and furniture for schools, libraries and homes. The business started nearly ten years ago when Mike Miller made a toy theatre for his grand-daughter which attracted a great deal of interest. From that small beginning Twoey Toys has grown and the company now manufactures and sells a wide range of toys, furniture and storage units. High quality and service are Twoey Toys' chief selling points.

But success brings its own problems: by 2004 Twoey Toys was working from four different sites in Wigton, Cumbria, which meant staff, materials and products had to be moved between the sites. That not only made operations inefficient, it also limited the scope for future growth.

Twoey Toys decided to commission a new building in Wigton which would enable all the company's operations to be consolidated on one site and give room for expansion.

THE BUILDING

The design of the new building was undertaken by Alpha Design of Cockermouth. The 1,200m² steel frame building has a two storey office block at the front, with a welcoming brick façade, and a large production and shipping area at the rear.

For the roof and the majority of the walls Alpha Design specified Steadmans' AS35 insulated panel cladding system. Composite panels were chosen as they offer rapid, straightforward construction, give a weather tight covering to roof and walls in one operation and form the internal and external finishes at the same time.

Glen Beattie of Alpha Design had used Steadmans' products on other projects and had been impressed not only with their quality, but also with the high standard of technical support and backup Steadmans provide both before and after supply.

He specified 80mm thick panels for the roof and 60mm thick panels for the walls. The panels were Merlin Grey, with flashings and guttering in lighter Goosewing Grey: the door and window frames were colour matched to the cladding.



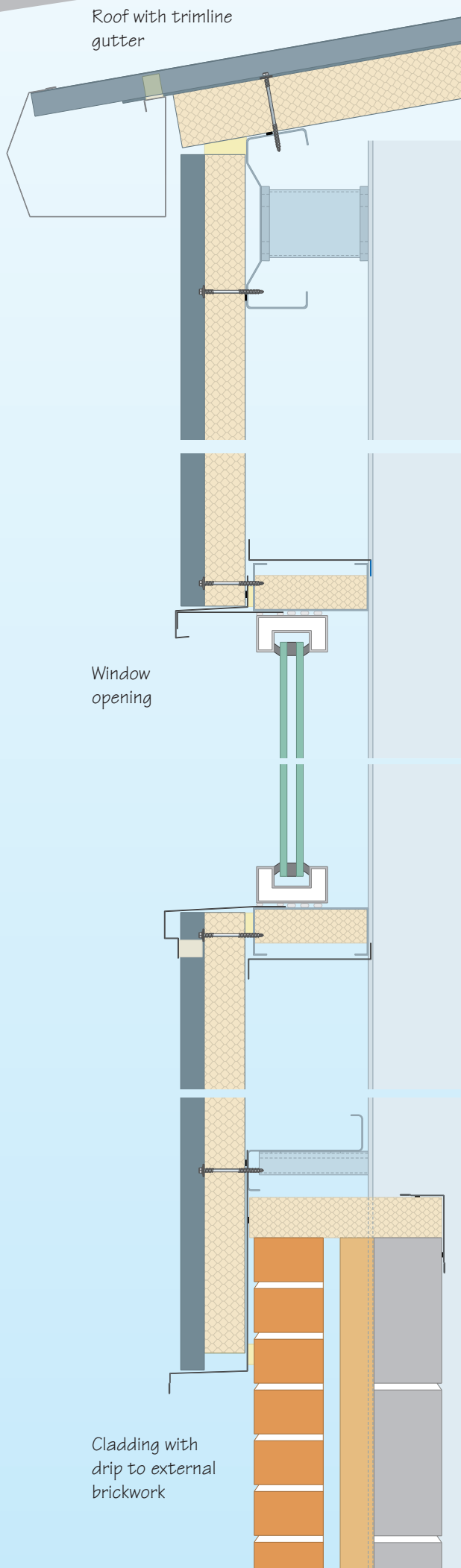

The 1342m² of roof panel and 371m² of wall panel were installed by PMS Fabrications Ltd for the main contractor Thomas Armstrong Construction Ltd.

As part of the compliance process for Part L of the Building Regulations the building was tested for airtightness by Stroma Technology Ltd. The result of 5.07m³/m²/hour @ 50 Pa, well within the required standard of 10m³/m²/hour @ 50 Pa.

ENVIRONMENT

Twoey Toys wanted to minimise the environmental impact of its operations, so the building includes a heating system which uses waste wood from production, not only saving on heating costs, but also saving over £5,000 a year on waste collection.

The specification of Steadmans AS35 panels has helped in the delivery of an energy efficient, durable building.

AS35 INSULATED PANELS

AS35 panels, which are manufactured in a ISO 9001 certified process consist of two coated steel profiles bonded to a core of PIR insulation; they can be used to form roofs down to 4° pitch and walls. The panels are available in lengths up to 12m, giving rapid coverage on site.

The PIR core, which has zero ozone depletion potential, has a very low thermal conductivity, allowing designers to specify high levels of thermal performance without requiring excessively thick panels. The long length of the AS35 panel reduces the number of end laps, helping to minimise air leakage and the associated heat loss.

AS35 panels are available in number of finishes, including Plastisol and Dobel Nova, in a wide range of colours and have a Guaranteed service life to first repainting of 30 years. Where high levels of fire protection are required AS35 Firefighter and Firefighter Plus panels should be specified.

Steadmans supply a full range of accessories for the panels including rooflights, gutters, flashings, fixings and sealants.

Steadmans also offer an independent audit based warranty for the AS35 panel system to ensure high standards of installation and to maximise the service life of the panels.

Sign of Quality

A Steadman and Son Limited (usually known as Steadmans) are one of the UK's leading manufacturers of roofing and cladding, supplying high quality cladding materials from our sites in England, Scotland and Northern Ireland. We offer total cladding and roofing solutions which we deliver with our dedicated haulage fleet.

Our continuous investment programme and on-going product development ensures we can provide high quality products promptly and at competitive prices.

A. Steadman & Son Ltd

England

Warnell, Welton, Carlisle
Cumbria CA5 7HH

Tel: 01697 478 277

Fax: 01697 478 530

Ireland

Unit 5,
Scarva Road Industrial Estate
Banbridge, Co. Down
Northern Ireland
BT32 3QD

Tel: 02840 660 516

Fax: 02840 660 517

E-mail: info@steadmans.co.uk

Online: www.steadmans.co.uk

AS35 insulated panel

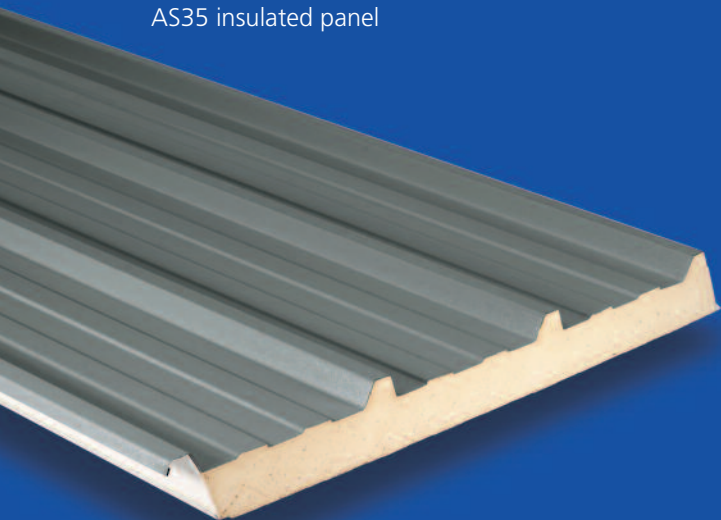

Steadmans

PROJECT PROFILE
TWOEY TOYS

